

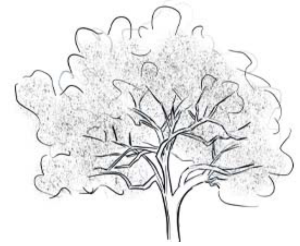

Gardens of Oak Hollow

A SMALL COMMUNITY WITH A BIG HEART

Neighborly News



Number 083
26 March 2024

HOA General Meeting



6PM, Tuesday, March 26
Brook Hollow Library

The meeting will be available only from 6 to 7:30 PM, with no early admission into the room. Plan on arriving at 6PM as possible. I am looking forward to seeing all of you at our Annual General Meeting.

Remember to bring your ballots !!!

Why 5 Feet From The Alley?



In case you do not know me very well, you may not know that I tend to question the rational for some rules. I like to think I can make my own decisions about my property.

My guess is, I am probably not alone with this feeling.

While I was reading our Covenants for our Community, I questioned Article VI, Section 3: "No fence building, shed, or awning shall be build nearer than five (5) feet to an alley." This seems restrictive for those neighbors who are blessed with alley access. So, I did some digging to find out why this restriction was included in our Covenants.

Turns out the five foot buffer IS needed. Here are the top three reasons in my opinion..

City Code

Turns out, five feet is requirement from the City Code, not the Homeowners Association. This is the relevant section of Table 207-4. You can find this in in San Antonio Municipal Code, Chapter 35 - Unified Development Code, Section 35-207 - Traditional Neighborhood Development.

Street Type	ROW Right of Way	Pavement Width
<p><i>Alley</i> 10' Pavement Width 20' Right-of-Way</p>	20'	10'—12'

Garbage Disposal

Every week we have garbage disposal trucks that visit our Community. Many

Emergency Vehicle Size and Weight Regulation Guideline

Custom Chassis Pumper – Single Rear Axle

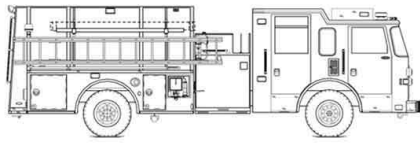

	Min	Max
Front GAWR	18,000	24,000
Rear GAWR	24,000	31,000
Width (in.)	98	100
Height (ft.)	9	12
Length (ft.)	30	34

Vehicle Turning Path Layouts

Semi-Trailer Truck - 40' WB

Outer Radius: 40'-40'10" | 12.2-12.4 m
Inner Radius: 19'4" | 5.9 m

Vehicle Wheelbase: 40' | 12.2 m
Vehicle Length: 45'6" | 13.87 m
Vehicle Width: 8' | 2.44 m

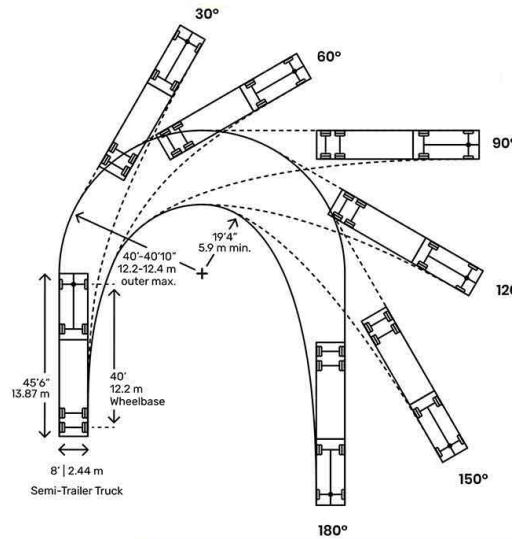

neighbors have their garbage bins located in the alley. Have you ever watched one of the large vehicles maneuver a turn into the alley? This is not a problem when they have the five foot buffer on each side. However if one side of the alley is blocked, the wheels of the big garbage trucks are likely to dig a trench in the yard on the opposite side of the blockage. The large vehicles have a wider turning radius than your car.

Emergency Vehicles

Hopefully we are never faced with the need for Emergency Vehicles. But in an emergency a large fire truck may need to access to the rear of the home. So just like the garbage disposal trucks, these large vehicles may need clear access to the alley ways. The larger fire trucks need even a greater turning radius.

After writing the article above that talked about Emergency Vehicles, it seemed like a good idea to include some information about residential fires.

The U.S. Fire Administration released the statistics for Residential Building Fire Causes (2012-2021). It reported that the 2021 national estimates for leading causes of residential building fires show that there were:

- 170,000 cooking fires
- 32,200 heating fires
- 29,800 other unintentional, careless fires (includes the misuse of materials or products, abandoned or discarded materials or products, heat source too close to combustibles, and other unintentional actions)
- 24,200 electrical malfunction fires

Overall trends in the leading fire causes for the 10-year period of 2012-2021 show the following:

Fire Safety Tips



Cooking as the leading cause of residential building fires for the 10-year period.

- ✔ A 4% decrease in residential cooking fires.
- ✔ A 37% decrease in residential heating fires.
- ↗ A 44% increase in residential other unintentionally or carelessly set fires.
- ↗ An 11% increase in residential electrical malfunction fires.

Rare Opportunity

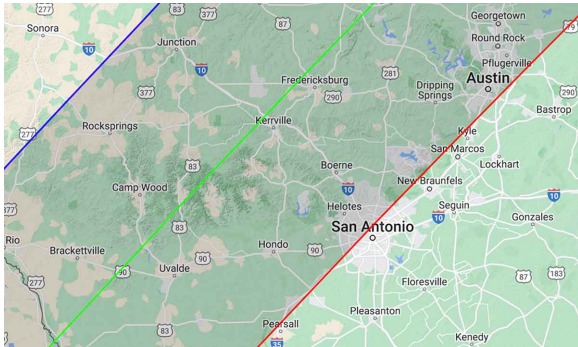

Do You Have Your Glasses?

The total solar eclipse on April 8, will occur when the Moon moves between the Earth and Sun completely obscuring the Sun. During totality, you may view the Sun without proper eye protection, such as solar glasses. But during all other phases of the eclipse, you should only look at the Sun when your eyes are protected.

1 Minute 12 Seconds of Totality

Peak at 01:34 PM

Here in the Gardens, we are fortunate to be within the edge of the totality viewing area.

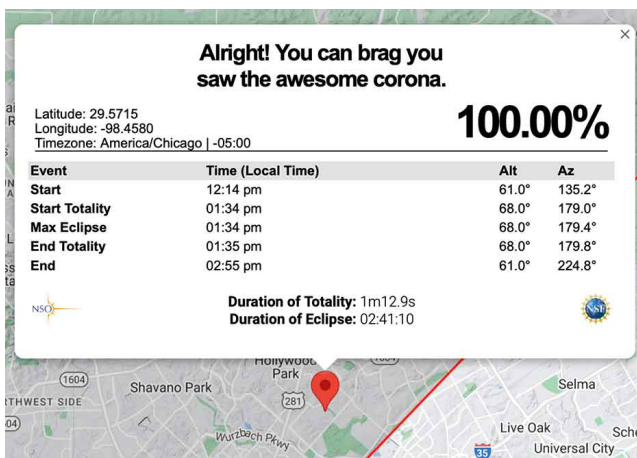

<https://nso.edu/for-public/eclipse-map-2024/>

Just For Fun

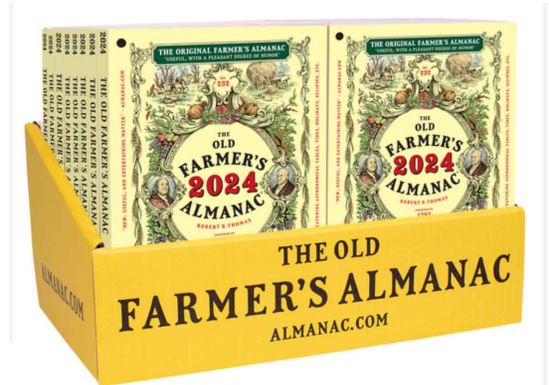

Question of the Day

What is the origin of the phrase “burning the candle at both ends”?

That phrase was coined by the American poet Edna St. Vincent Millay in 1920. It comes from her poem “First Fig”: “My candle burns at both ends; / It will not last the night; / But ah, my foes, and oh, my friends— / It gives a lovely light!”.

Advice of the Day

When sheep collect and huddle, Tomorrow will become a puddle.

Puzzle of the Day

What word is that to which if you add a syllable, it will make it shorter?

Short.

Word of the Day

Node: Either of the two points where a body’s orbit intersects the ecliptic.

Ascending: The body is moving from south to north of the ecliptic. **Descending:** The body is moving from north to south of the ecliptic.